

# OCEA Installation Manual

For technical support, please email [support@evervue.com](mailto:support@evervue.com).  
Mention your order number.



## Ocea Recessed Mount Installation

1. Make an opening in the wall, 2.3"/60mm deep and install the wall box for the TV and the sound bar. Also prepare the power cable from the power supply.

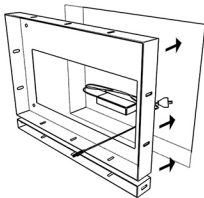

2. Connect the power cable to the TV. Close the cable compartment. (optional: Connect RF cable, Antenna, or HDMI).

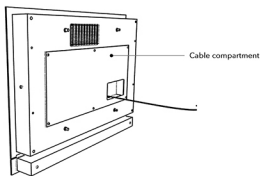

3. First insert the sound bar in the wall box, and then the TV unit in wall box. The special magnet will keep the TV unit and the sound bar in place. If you prefer, you can seal the edges of the front with a silicon glue (recommended for commercial use).

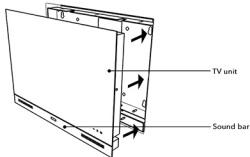

4. Turn on the TV with the remote control, or the touch on/off button. Connect the OCEA to your local Wi-Fi network



5. You are now ready to enjoy your OCEA TV.

