

Bluetooth Keyboard

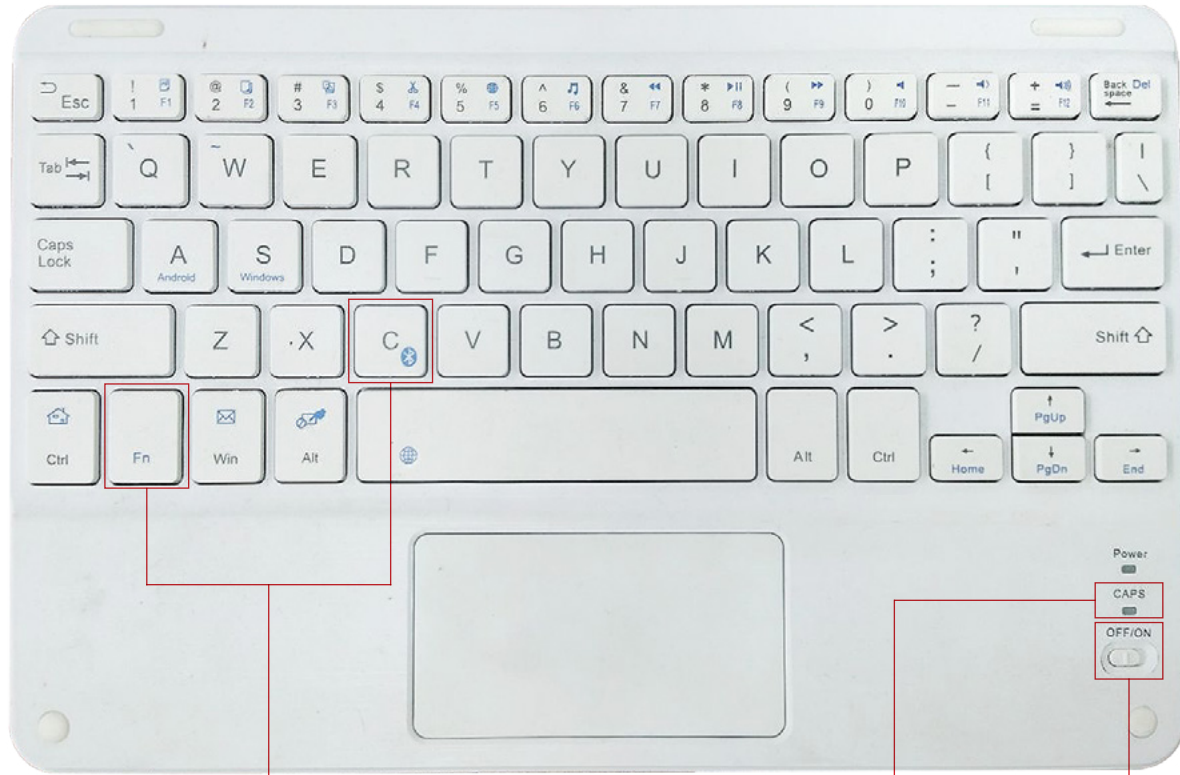

Step 2

Step 3

Step 1

1 Turn the button ON.

2 Long press “Fn” and “C” at the same time.

3 If the CAPS light turns blue, find the matching bluetooth device in the settings of your TV and connect it. Follow the prompts for successful connection.

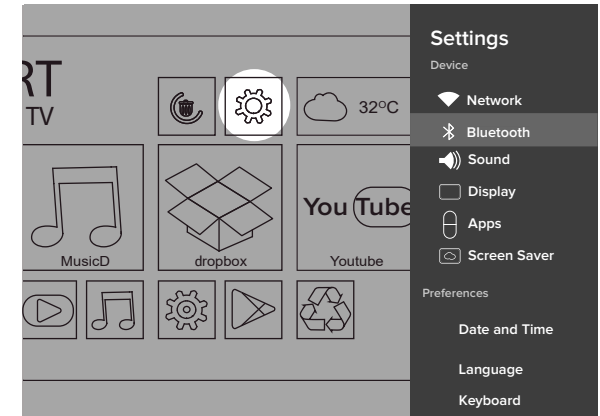

4 If you don't have a Bluetooth keyboard, use the black remote to control your TV.