

PARTS

Front View of CabiTV CT200

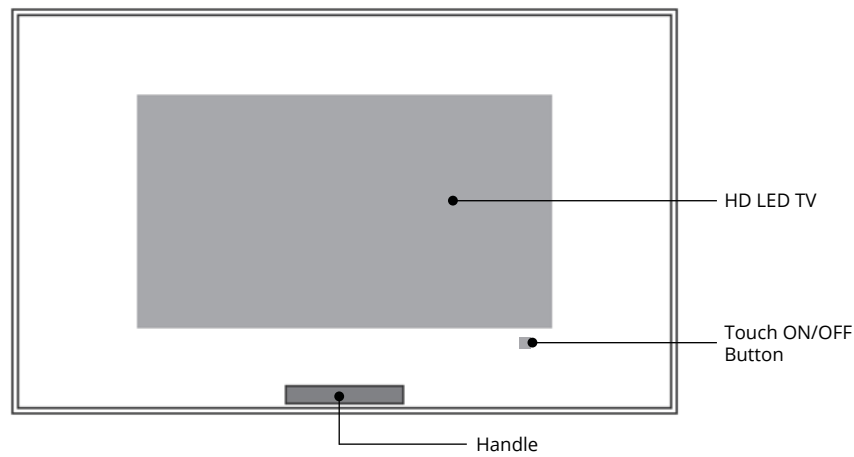

Right Side View of CabiTV CT200

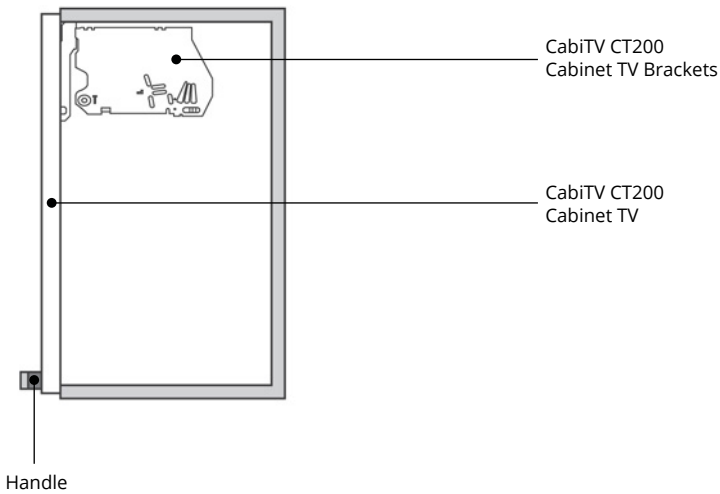

TV Ports

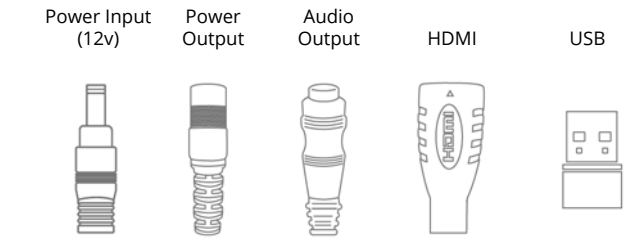

Accessories

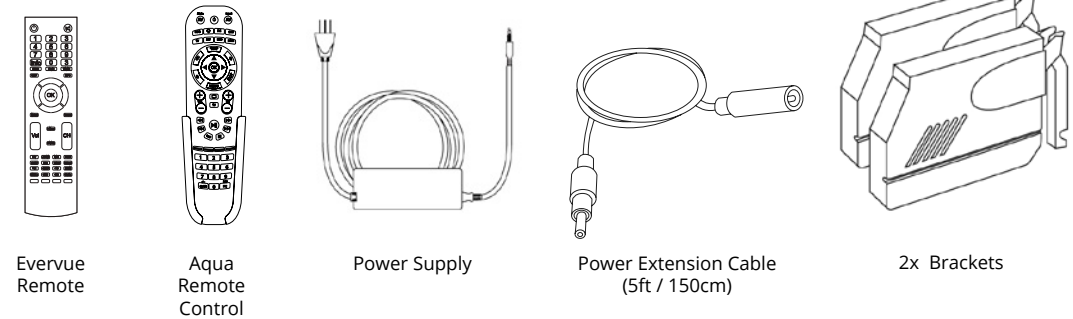

1 Unboxing

Upon receiving your order, open the crate and inspect the content. Damages must be reported within 24 hours.

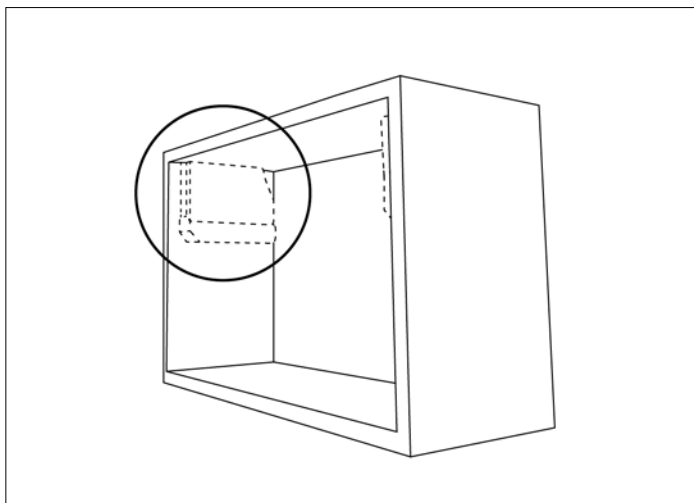

2 Plan the Installation of CabiTV CT200

Plan where you will install the CabiTV CT200. The unit is custom made to fit in your cabinet.

Note: Install the bracket exactly on the right location.

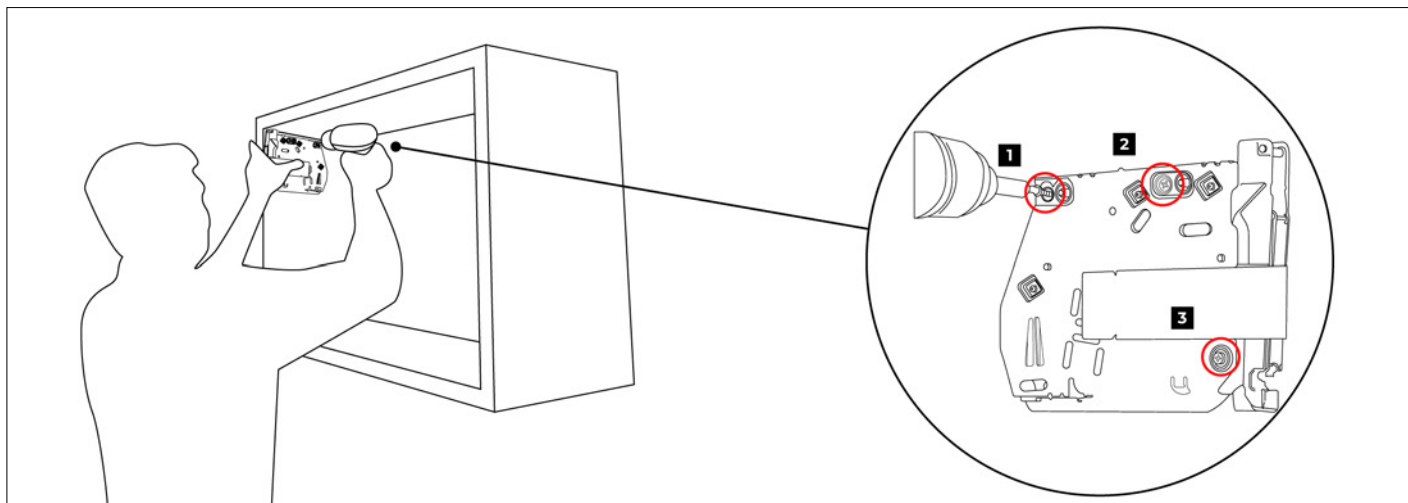

3 Install the Brackets

Install the brackets inside the cabinet. Screw the brackets on the points shown above.

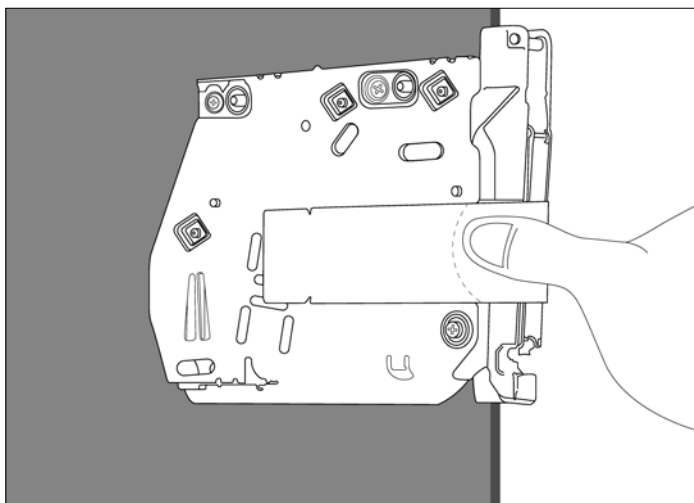

4 Remove the Seal

Remove the seal of the bracket by pressing it inwards. Pull off the seal afterwards.

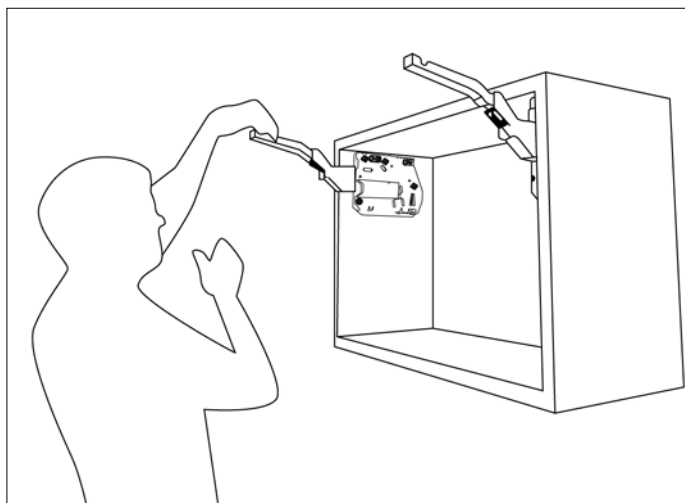

5 Pull the Arm Brackets

Pull the arm brackets gently towards you.



6 Safety Precaution: Lever Springs Upward

There is a danger of injury if the lever springs upward. After opening, do not push down on the lever.

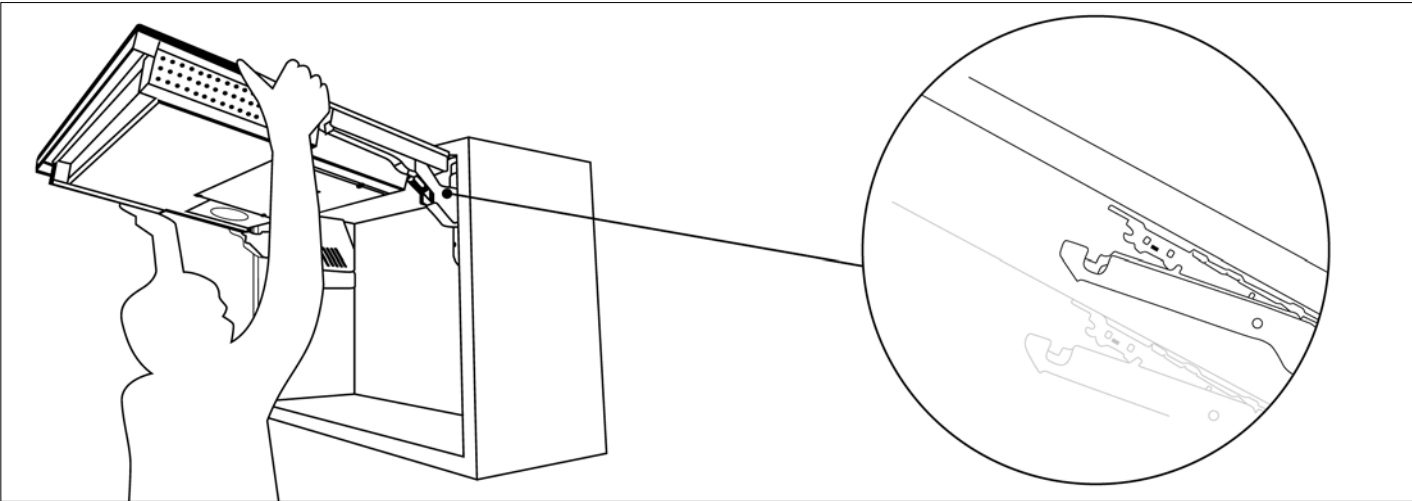

6 Attach the CabiTV CT200
Make sure that the arm brackets “click” into the TV unit. Ask for assistance when attaching the CabiTV CT200 to avoid injuries.

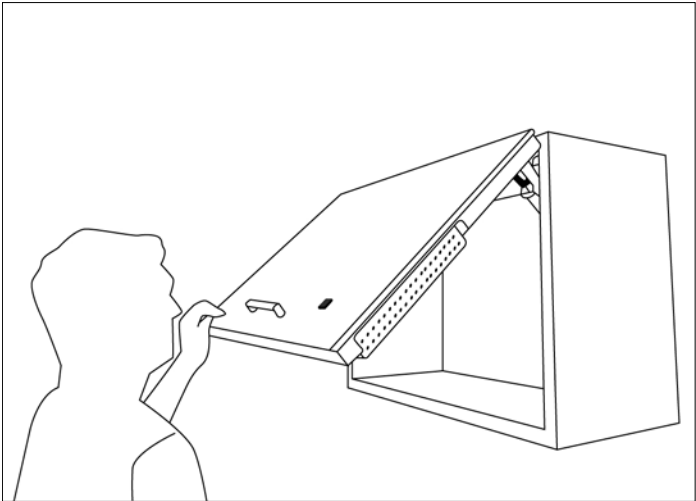

7 Test the CabiTV CT200
Test the CT200 by closing and opening a few times.

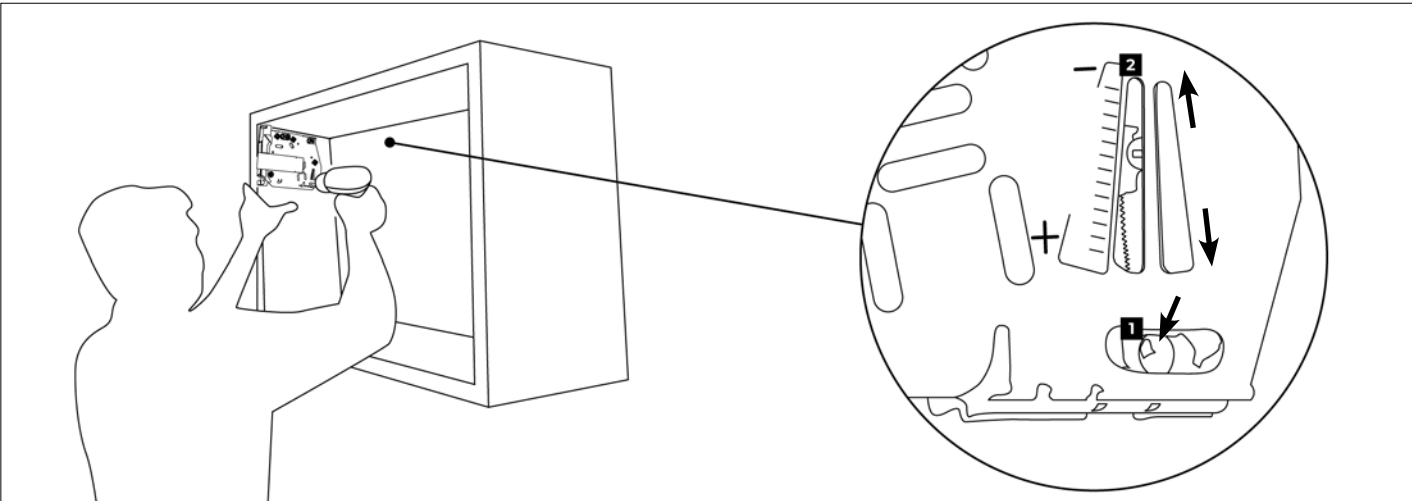

8 Adjust the Strenght of Arm Brackets
With the screw provided, you can adjust the CabiTV up and down to make it fit.

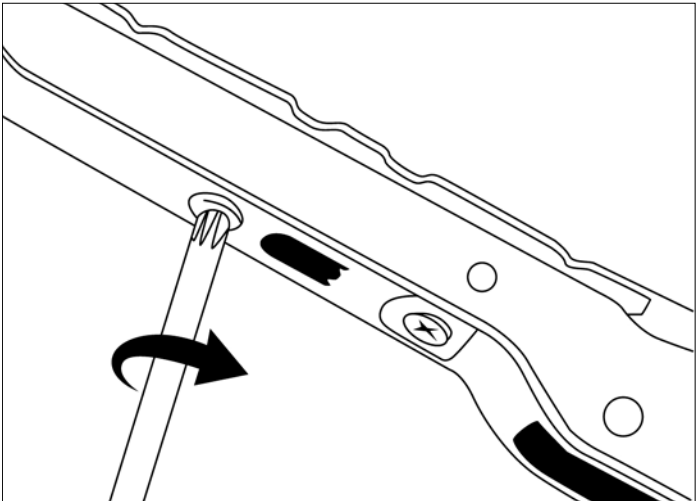

9 Tighten Screws
Tighten the screws on both arms.

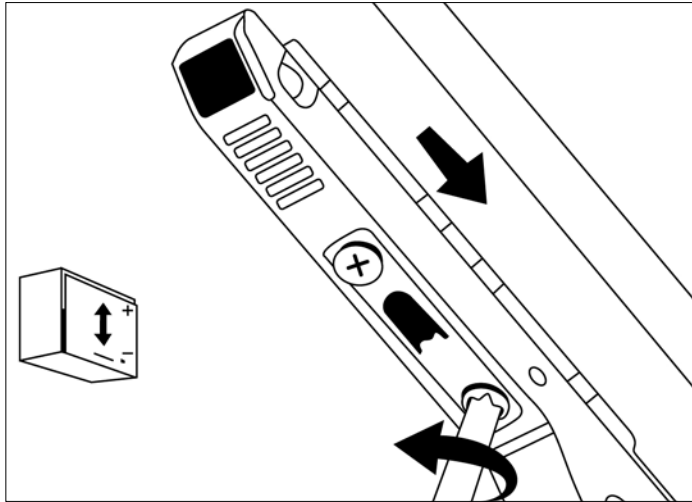

- 10 Adjust the CabiTV Up and Down**
With the screw provided, you can adjust the CabiTV up and down to make it fit.

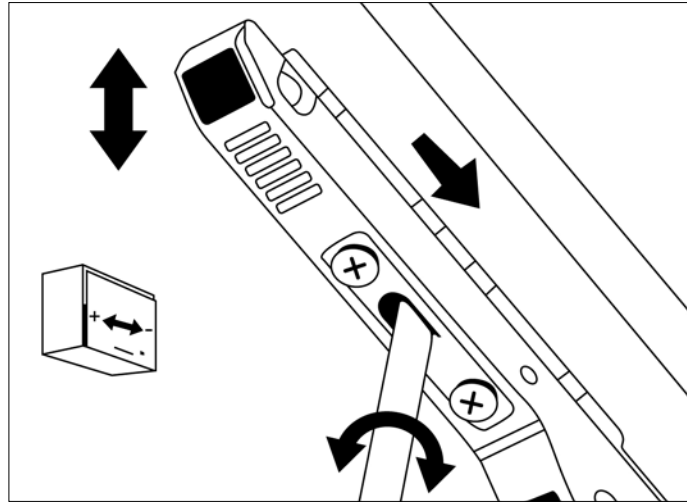

- 11 Adjust the CabiTV Left and Right**
With the screw provided, you can adjust the CabiTV left and right to make it fit.

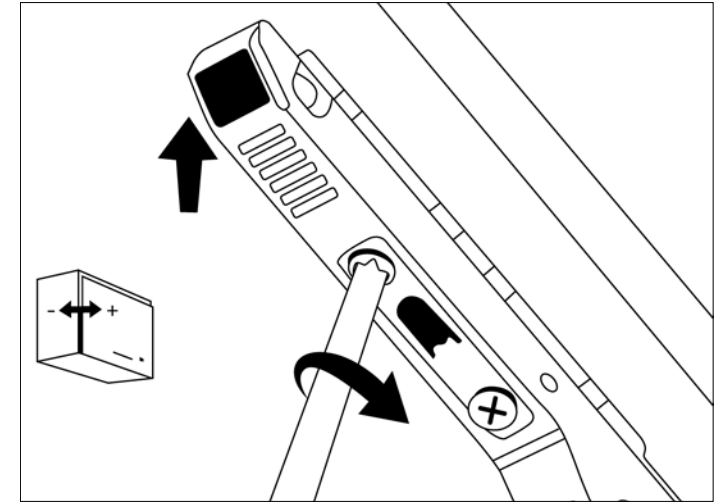

- 12 Adjust CabiTV when Closing**
With the screw provided, you can move the CabiTV towards you in closed position.

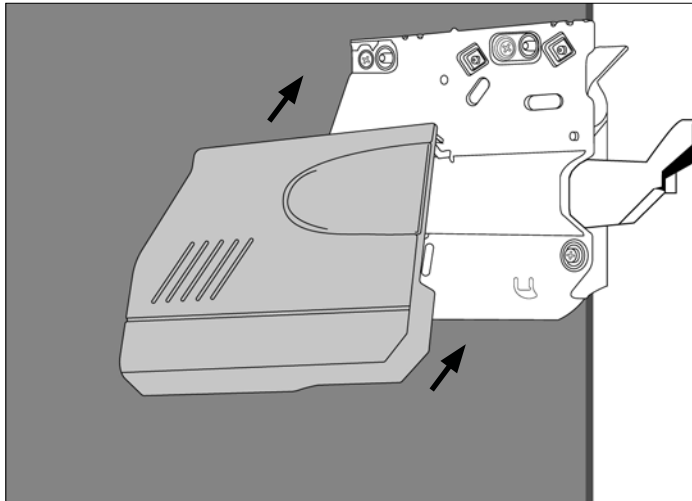

- 13 Cover the Brackets**
Cover the brackets after attaching the brackets with its plastic case.

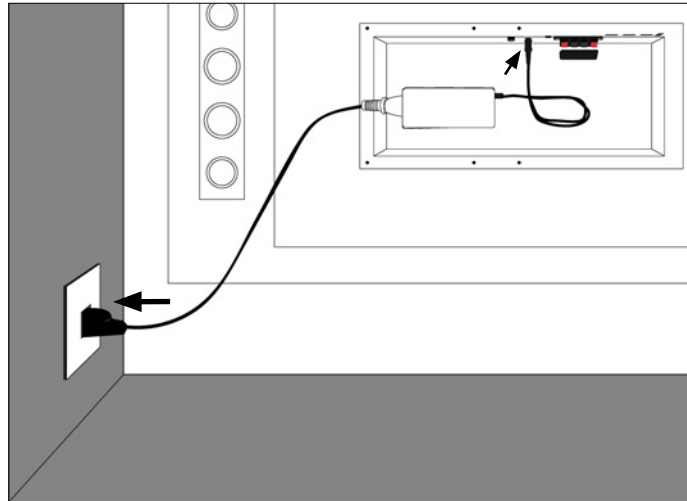

- 14 Plug the Power Supply**
Plug in the power supply of the CabiTV or plug in the HDMI or VGA depending on the configuration.

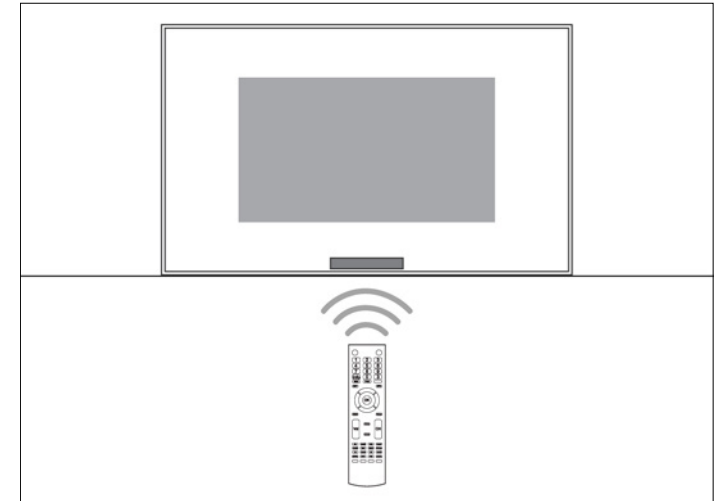

- 15 CabiTV CT200 is Ready**
Turn the CabiTV on using the Evervue remote or press the power button on the front of the screen.