

MIRROR WITH INTEGRATED LIGHTS (Recessed Mount)

Installation Manual

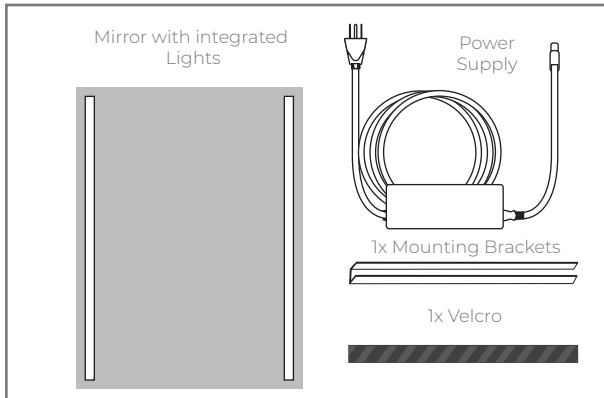

1 Check the items after receiving

Before installing, check to ensure that you have received all the package contents.



2 Screw the two brackets to the wall.

Ensure the wall is correctly prepared for installation. Determine the type of screws needed for the surface you are mounting to. Drill holes into the bracket and screw it to the wall. Attach the velcro to the wall as well.

(Note: It is the installer's responsibility that all electrical, audio/visual, and framing construction is code compliant.)

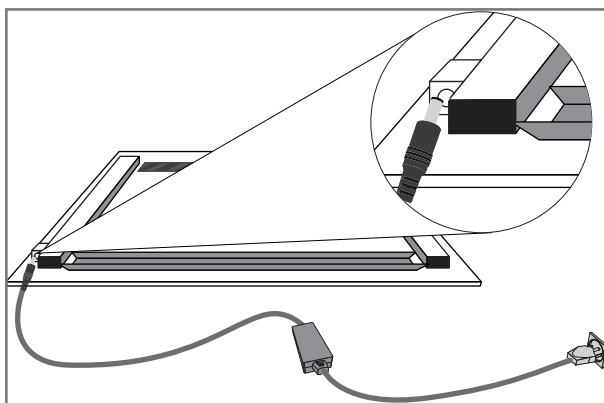

3 Plug and test.

Lay the Integrated Lights Mirror flat on a padded surface to connect the cable to the ports. Test the power source. Then lift the mirror up.

(Note: Please make sure that the mirror glass is protected during the execution of this step.)

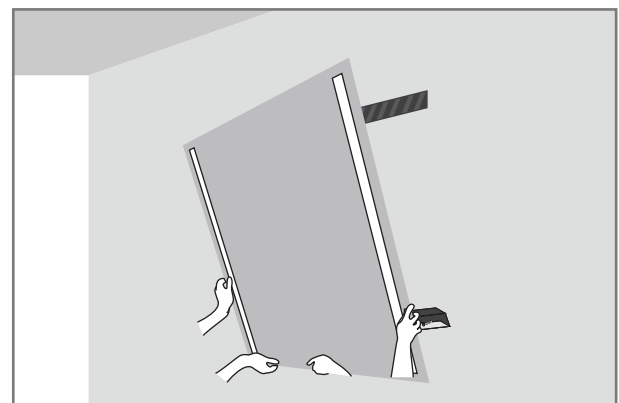

4 Hang the mirror up.

Carefully lift the mirror and securely engage the mounting bracket and the velcro on the back of the mirror to their counterparts installed on the wall.

(Note: It is recommended that 2 or more people assist in the installation of this mirror.)

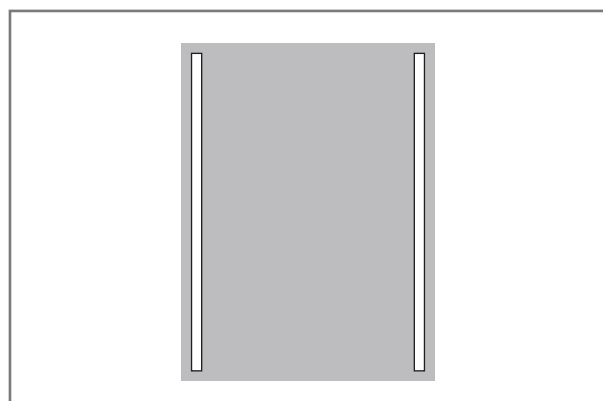

5 Finished.

Enjoy your new Integrated Lights Mirror .