

# Panel Testing mode (4k TV System)

## Installation Manual

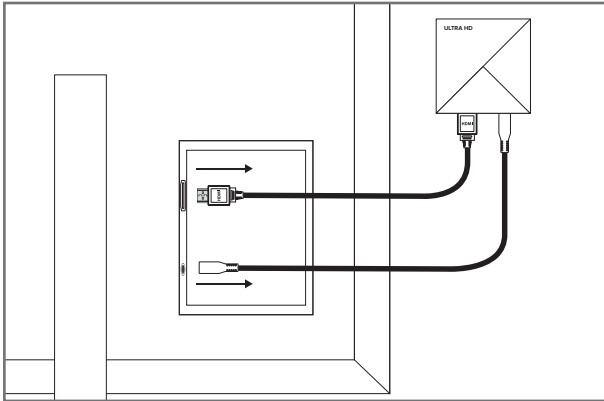

### 1 Remove the android box from the TV.

On the back of your tv, find the small android box attached to it and remove it from the TV.

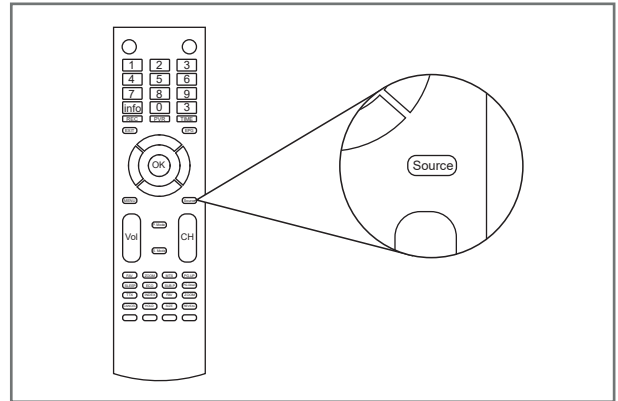

### 2 Press the Source button

Find and press the "Source" button on the remote.

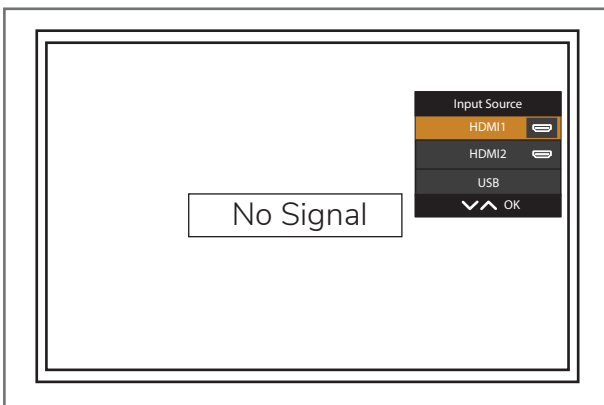

### 3 Highlight the HDMI1 input

An input source menu would pop up at the top right portion of your screen. Highlight the HDMI1 option but do not press it.

(Note: If the HDMI1 button is accidentally pressed, press the "Exit" button and go back to step 2.)

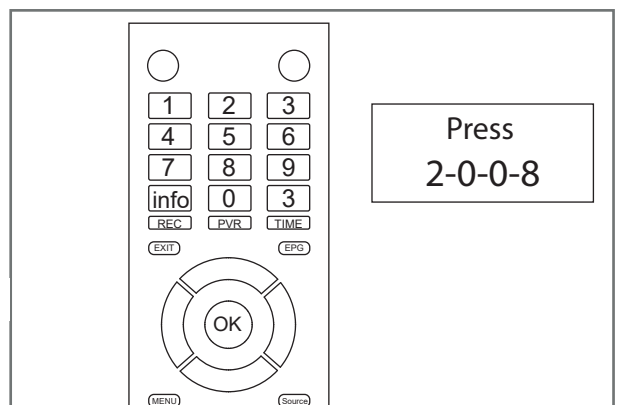

### 4 Press 2-0-0-8

Slowly press the numbers 2-0-0-8 on the remote to bring the "Design settings" up.

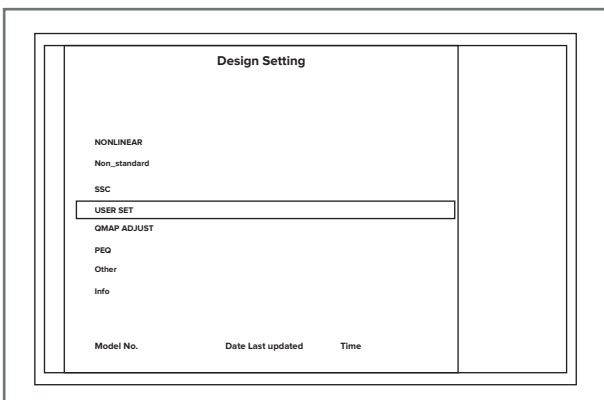

### 5 Press User Set

Under "Design Settings" press "User Set".

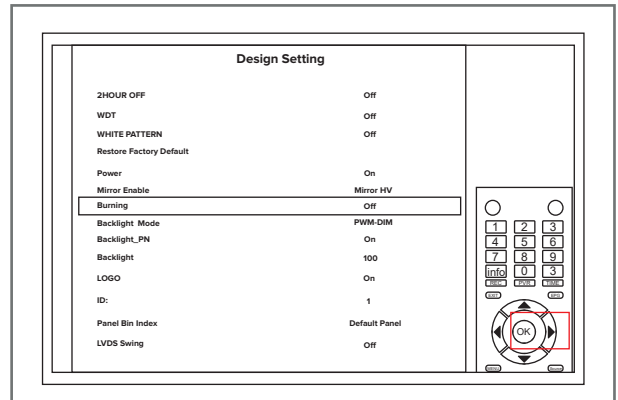

### 6 Press Burning

User "User Set" find the burning option then press enter followed by the button on the remote.

# Panel Testing mode (4k TV System)

## Installation Manual

**EVERVUE**<sup>®</sup>

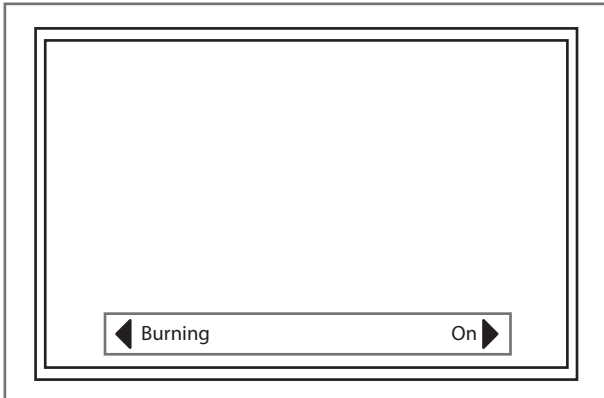

### 7 Set burning to On

The burning settings would pop up on the bottom part of the screen. Again press the ► button to set burning to on.

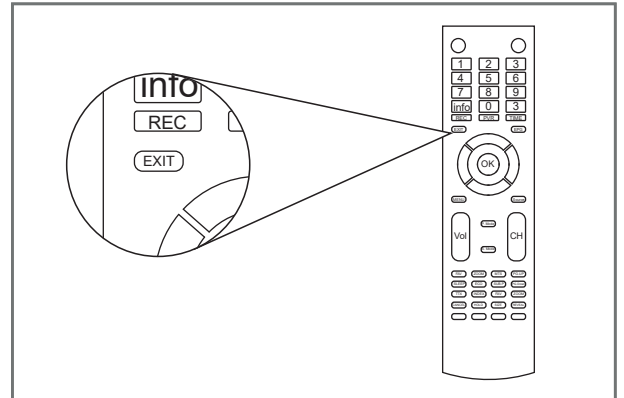

### 8 Press Exit

Press the "Exit" button on the remote to go back to the main TV screen.